

### "P-1NN/\*" CONTROL

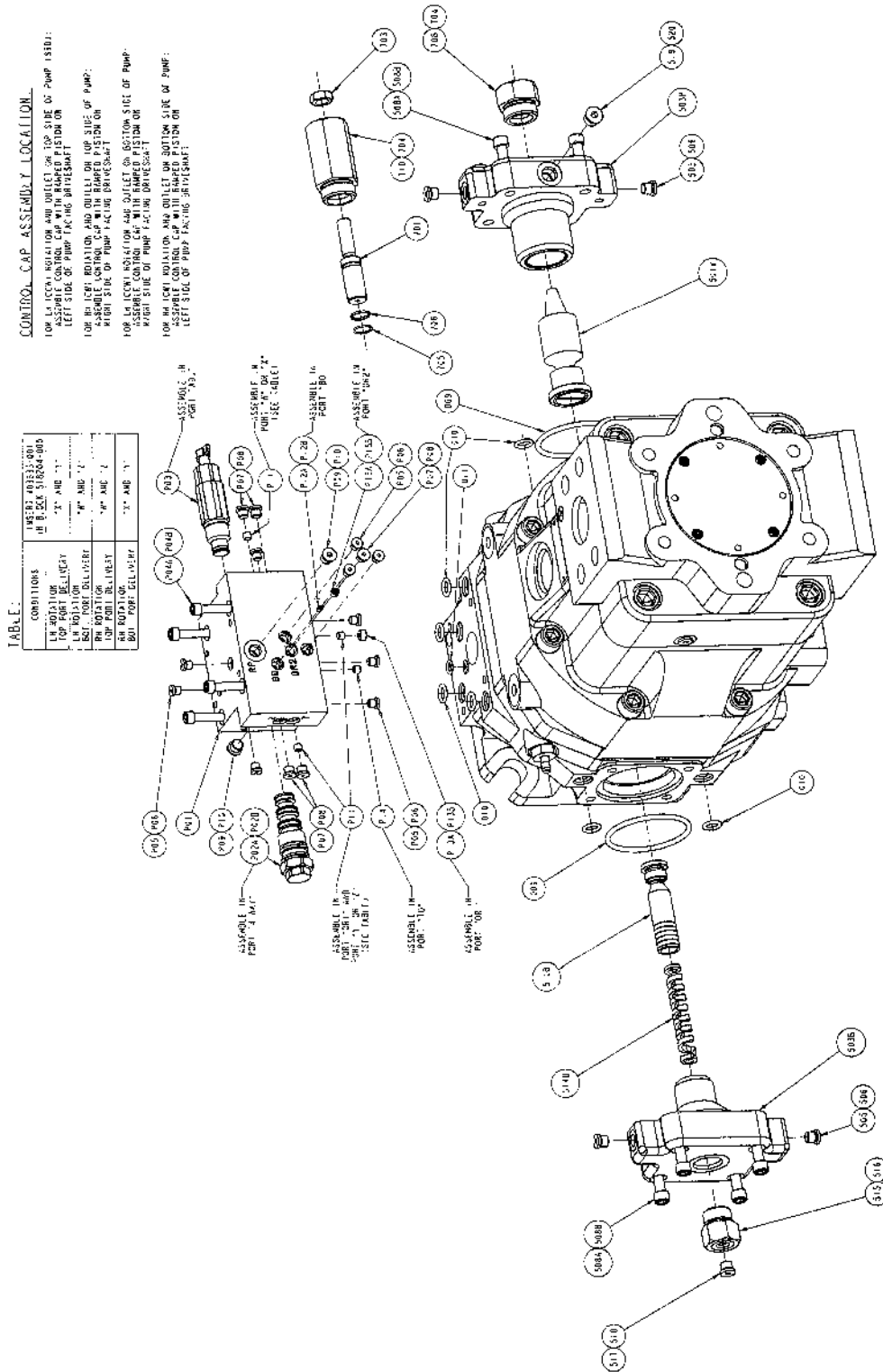

#### Parts Drawing

#### Pressure Compensator and Options



**CONTROL CAP ASSEMBLY LOCATION**

FOR LEFT ROTATION AND OUTLET ON TOP SIDE OF PUMP ASSEMBLY:  
 ASSEMBLE CONTROL CAP WITH DAMPED PISTON ON LEFT SIDE OF PUMP FACING DRIVE SHAFT.

FOR LEFT ROTATION AND OUTLET ON TOP SIDE OF PUMP:  
 ASSEMBLE CONTROL CAP WITH DAMPED PISTON ON RIGHT SIDE OF PUMP FACING DRIVE SHAFT.

FOR LEFT ROTATION AND OUTLET ON BOTTOM SIDE OF PUMP:  
 ASSEMBLE CONTROL CAP WITH DAMPED PISTON ON LEFT SIDE OF PUMP FACING DRIVE SHAFT.

FOR RIGHT ROTATION AND OUTLET ON BOTTOM SIDE OF PUMP:  
 ASSEMBLE CONTROL CAP WITH DAMPED PISTON ON RIGHT SIDE OF PUMP FACING DRIVE SHAFT.

TABLE:

CONDITIONS	INLET PORT	OUTLET PORT
LR ROTATION TOP PORT DELIVERY	"A"	"V"
LR ROTATION BOTH PORTS DELIVERY	"A"	"V"
RR ROTATION TOP PORT DELIVERY	"A"	"V"
RR ROTATION BOTH PORTS DELIVERY	"A"	"V"

518669 sht. 1

# Oilgear

## PUMP, VARIABLE DELIVERY PVV-200 & 250

MAINTENANCE

2

### "P-1NN/\*" CONTROL



Parts Drawing

Pressure Compensator and Options

Parts used in this assembly are per Oilgear specifications. Use Oilgear parts to ensure compatability with assembly requirements. When ordering replacement parts, be sure to include pump type designation, serial number, Data Sheet (DS-) number and item number. To assure seal and packing compatibility, specify type of hydraulic fluid used.

ITEM NO.	DESCRIPTION
700	VOLUME STOP ASSEMBLY
701	Stop, Max. Volume
703	Nut, Lock
704	Seal, O'ring
705	Seal, O'ring
706	Ring, Back-up
708	Plug, Max. Stop
710	Gland, Max. Stop
P-1	CONTROL ASSEMBLY
P01	Block, P-Control
P02A	Valve, 4-Way (Viton) HS4WPP1-802-RP
P02B	Valve, 4-Way (Buna) HS4WPP1-802-RP-B
P03	Valve, Relief HSLR-603-P-50-4
P04A	Screw, S.H.C. SAE
P04B	Screw, S.H.C. Metric
P05	Plug, Hollow Hex.
P06	Seal, O'ring
P07	Plug, Hollow Hex.
P08	Seal, O'ring
P09	Plug, Hollow Hex.
P10	Seal, O'ring
P11	Plug, Pipe
P12	Screw, Orifice Set
P13	Plug, Orifice
P14	Plug, Orifice
P15	Plug, Orifice

ITEM NO.	DESCRIPTION
009	COMMON ASSEMBLY
010	GROUP
011	Seal, O'ring
501V	CONTROL HEAD ASSEMBLY
503B	Assembly, Control Piston/Shoe
503P	Assembly, Bias Control Cap/Sleeve
505	Assembly, Pressure Control Cap/Sleeve
506	Plug, Hollow Hex.
508A	Seal, O'ring
508B	Screw, S.H.C. SAE
510B	Screw, S.H.C. Metric Assembly, Bias Control Piston/Shoe
514B	Spring, Bias Piston
515	Plug, Min. Stop
516	Seal, O'ring
517	Plug, Hollow Hex.
518	Seal, O'ring
519	Plug, Hollow Hex.
520	Seal, O'ring

O'RING and BACK-UP RING SIZE  
Cross Section x O.D. Duro ±5

ITEM NO.	SIZE
009	3/16 x 3-7/8
010	1/8 x 3/4
011	3/32 x 9/16
506	904 ARP
520	906 ARP
704	916 ARP
705	1/16 x 3/4
706	016
P06	902 ARP
P08	903 ARP
P10	904 ARP

## "P-1NN/\*" CONTROL



### Parts Drawing

### Pressure Compensator Control Options

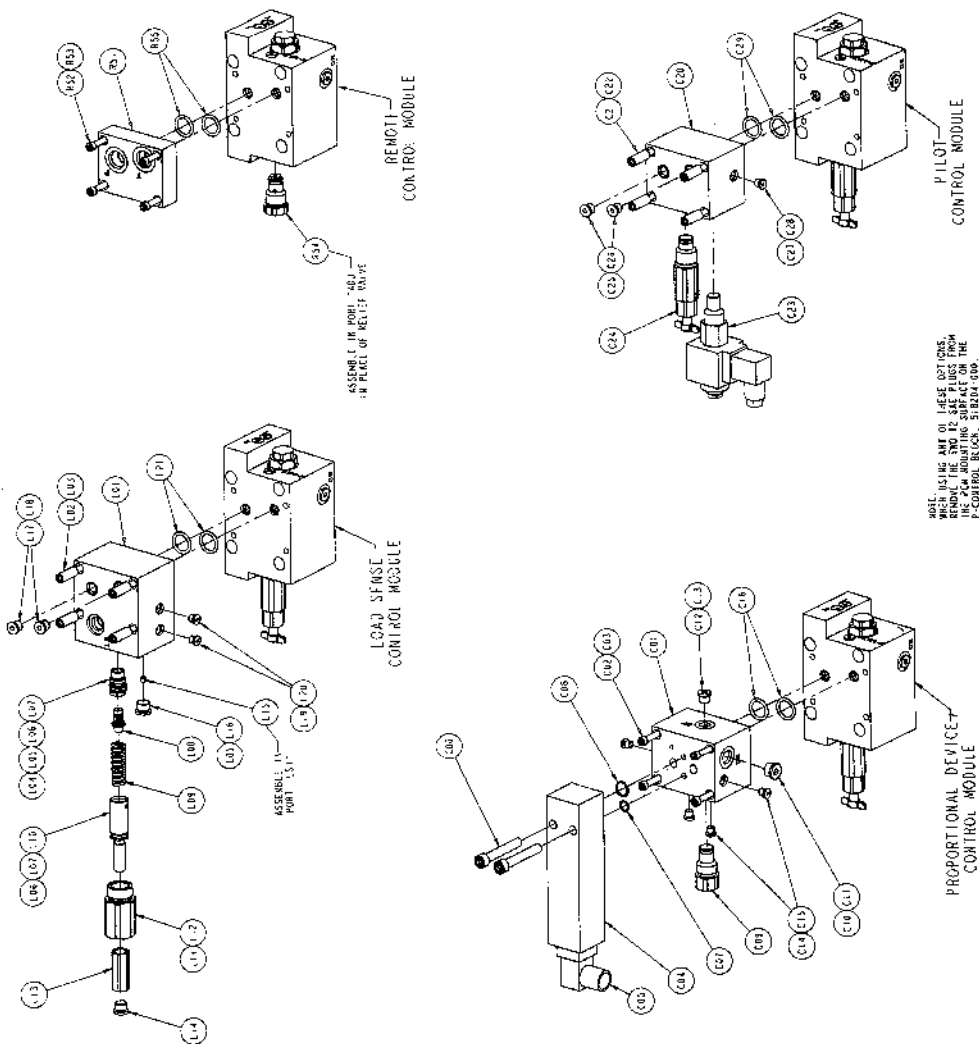

# Oilgear

## PUMP, VARIABLE DELIVERY PVV-200 & 250

MAINTENANCE

4

## "P-1NN/\*" CONTROL



### Parts List

### Pressure Compensator Control Options

Parts used in this assembly are per Oilgear specifications. Use Oilgear parts to ensure compatibility with assembly requirements. When ordering replacement parts, be sure to include pump type designation, serial number, Data Sheet (DS-) number and item number. To assure seal and packing-compatibility, specify type of hydraulic fluid used.

ITEM NO.	DESCRIPTION	ITEM NO.	DESCRIPTION	ITEM NO.	DESCRIPTION	ITEM NO.	DESCRIPTION	ITEM NO.	DESCRIPTION
C01	P-A & P-B PROPORTIONAL Block, Control Module	L01	LOAD SENSE OPTIONS Block, Load Sense	C20	PILOT CONTROL PARTS Block, HSPCM601-M-1-C-BK	R51	REMOTE CONTROL Block, Remote Control	F05	O-RING and BACK-UP RING SIZE 906 ARP
C02	Screw, S.H.C.	L02	Screw, Stacking	C21	Screw, Stacking	R52	Screw, S.H.C.	F06	1/16 x 3/4
C03	Washer, Lock	F03	Washer, Lock	C22	Washer, Lock	R53	Washer, Lock	F07	016
C04	Control, Proportional Pres.	F04	Seat, Load Sense	C23	Valve, Two-Way	R54	Plug, Fixed Flow	F12	912 ARP
C05	Connector, Elect.	F05	Seat, O'ring	C24	Valve, Relief	R55	HSFF600-000 Seal, O'ring	F18	904 ARP
C06	Screw, S.H.C.	F06	Seat, O'ring		HSLR603-P-50-4			F20	902 ARP
C07	Seal, O'ring	F07	Seat, O'ring	C25	Plug, Hollow Hex.			F21	1/8 x 1
C08	Seal, O'ring	F08	Spool, Load Sense	C26	Seal, O'ring			C07	1/16 x 1/2
C09	Fuse, Contamination	F09	Spring, Load Sense	C27	Plug, Hollow Hex.			C08	1/16 x 11/16
C10	Plug, Hollow Hex.	F10	Screw, Load Sense Adj.	C28	Seal, O'ring			C11	906 ARP
C11	Seal, O'ring	F11	Bonnet, Load Sense	C29	Seal, O'ring			C13	904 ARP
C12	Plug, Hollow Hex.	F12	Seal, O'ring					C15	902 ARP
C13	Seat, O'ring	F13	Nut, Coupling					C16	1/8 x 1
C14	Plug, Hollow Hex.	F14	Plug, Hollow Hex.					C26	904 ARP
C15	Seal, O'ring	F15	Screw, Set					C28	902 ARP
C16	Seal, O'ring	F16	Plug, Hollow Hex.					C29	1/8 x 1